



P L A N T E R W O R X



UBR - Design Collective - Planting Bed System - Powder Coated Aluminum



POWERED BY PASSION

As an industry leader of landscape products, Planterworx prides itself in our attention to detail and our commitment to creating beautiful lasting objects. Our challenge is to create products that are both visually desirable and technically durable. Many of our product examples are intended to serve as inspiration. We are capable of a simple selective change or an extensive modification. Tell us your requirements and we will do everything to fulfill them.

All Planterworx products will be executed with our stringent commitment to timeless design and lasting quality, paying full attention to every last detail.

One of our great pleasures is working with creative and innovative members of the design community. We derive a great sense of gratification in helping you realize your vision.

We are here to help. With four lines to choose from, our products are as flexible as you need them to be.

All Planterworx products are made from the finest materials and are proudly designed and meticulously manufactured in Brooklyn, New York.

If you ever find yourself in our neck of the woods, please feel free to come by and say hello.

THE HOME COLLECTION

Planterworx Home is design made simple. The home collection is our entry level product line that brings our legendary quality into the home at unbelievable prices. We redesigned our entire manufacturing process to create a product that is versatile as it is beautiful.

Offered in two materials, corten steel and powder coated aluminum. Corten is a natural finish and aluminum is available, in either matte silver or pewter powder coated finishes.

The home collection is manufactured in specific sizes with limited finish options. Sizes and finishes can not be modified. All Home products are manufactured from .065" thick material.

Planterworx Home was designed with the residential DIY'er in mind, looking to achieve a professional installation result. The home collection makes any job easy.

We did the work so you don't have to.





True Square 20 and Ranch 16 - Pewter Powder Coated Aluminum

THE ELEMENT



E 16



E 19



E 44

Available in Corten Steel and Powder Coated Aluminum.

E 16 - 16" X 15.5" X 11"

E 19 - 19" X 20" X 11"

E 44 - 16" X 44" X 16"



Element Series - E 19, E 16, and E 44 - Corten Steel



Ranch 16 - Corten Steel

RANCH



Available in Corten Steel and Powder Coated Aluminum.

16" x 46" x 16"

20" x 40" x 16"

SQUARE TAPER



Available in Corten Steel and Powder Coated Aluminum.

16" x 16" x 16"

20" x 20" x 20"

30" x 16" x 16"

42" x 16" x 16"



Tapered Square 42 - Pewter Powder Coated Aluminum



True Square 16 and 20 - Silver Powder Coated Aluminum

TRUE SQUARE



Available in Corten Steel and Powder Coated Aluminum.

16" x 16" x 16"

20" x 20" x 20"



Baccarat Hotel NYC - Harrison Green - The Standard Planter - Matte Black Powder Coated Aluminum



CONTRACT COLLECTION

Planterworx Contract is what started it all.

The core of our product offerings is our contract collection. Manufactured in New York City for New York City, withstanding the test of time, our contract products can handle what the Big Apple or anywhere else can throw at them! As they say, "If they can make it here, they can make it anywhere!" This truth makes our core collection strong and durable with an incredibly long life span, while adding value to any project. Available in nearly any size, accommodating all types of architecture, these made to order products are available in corten steel, stainless steel, and powder coated aluminum.

For our aluminum products we offer a polyester based, architectural / marine grade powder coat in one of our standard finishes or any RAL color. Planterworx Contract offers nearly limitless possibilities and is sold only to the trade. All pricing for Planterworx Contract is net to the trade.

CONTRACT STYLE OPTIONS



ASTOR



METROPOLITAN



EMPIRE

Available in Corten Steel, Stainless Steel, and Powder Coated Aluminum.

Contract products can be manufactured to nearly any size.



Gramercy Terrace - Empire Planter - Black Powder Coated Aluminum



Square Taper - Corten Steel

CONTRACT STYLE OPTIONS

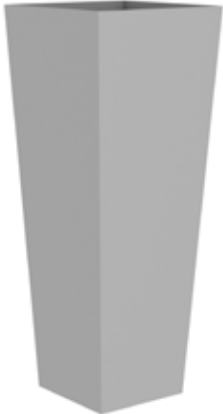

THE SQUARE TAPER



THE ROUND TAPER



THE CYLINDER

Available in Corten Steel, Stainless Steel, and Powder Coated Aluminum.

Contract products can be manufactured to nearly any size.

THE STANDARD



THE STANDARD



THE STANDARD W/ CASTERS



THE STANDARD W/ LEVELING KIT

Available in Corten Steel, Stainless Steel, and Powder Coated Aluminum.

Contract products can be manufactured to nearly any size.



Upper West Side Terrace - Nina Kramer - The Standard Planter - Powder Coated Aluminum



CONTRACT ELEMENT



E 16



E 19



E 30

Available in Corten Steel, Stainless Steel*, and Powder Coated Aluminum.

E 16 - 16" x 15.5" x 11"

E 19 - 19" x 20" x 11"

E 30 - 29.5" x 28.875" x 14.5"

*NDSF Only

CONTRACT ELEMENT



Available in Corten Steel, Stainless Steel*, and Powder Coated Aluminum.

E 44 - 16" x 44" x 16"

E 64 - 23.25" x 63.75" x 23.25"

E 91 - 26.5" x 91" x 30"

*NDSF Only



PLANTERWORX XP

Planterworx XP is comprised of 3 product solutions. Each product is designed based on the criteria of the installation. Our systems do not deviate from the design intent of any project. All systems can be installed at grade or on structure. All Planterworx XP products are designed as a complete solution, installed by any construction professional. There is no exposed hardware within our systems and field welding is not required with any of our products. Our systems are available in corten steel, stainless steel and powder coated aluminum.

Comprehensive shop drawings and installation instructions are supplied with each project. Should you require additional information regarding the XP product line, please do not hesitate to contact one of our product specialists.

Planterworx XP is sold only to the trade.

All pricing for Planterworx XP is net to the trade.



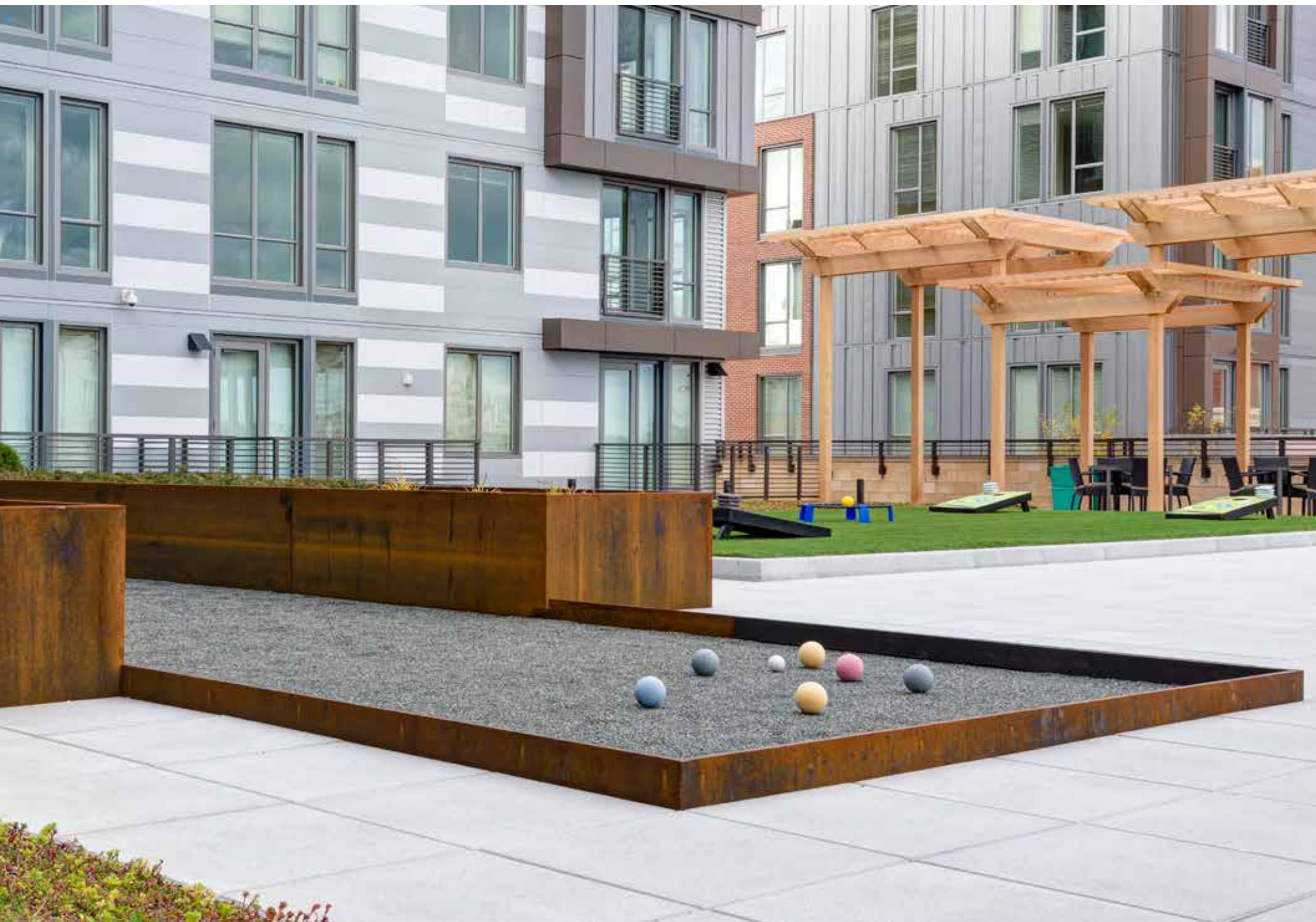

Flats on D - KZLA - Planting Bed System and Edging System - Corten Steel



RETAINING WALL SYSTEM

The Planterworx Retaining Wall system was developed for large scale planter environments. This system is manufactured in components based on the site specific configuration and architecture. This system has endless design possibilities. We are capable of manufacturing nearly any configuration. All corner conditions are factory welded, therefore each angle is established as an integrated component.

RETAINING WALL OPTIONS

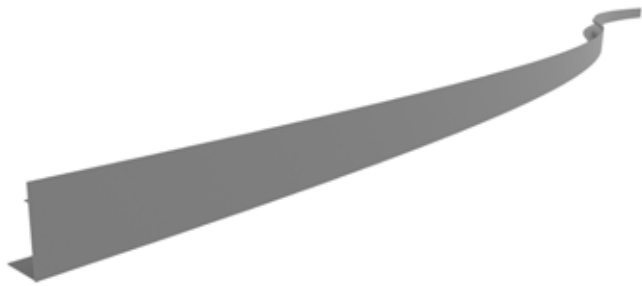

S-CURVE

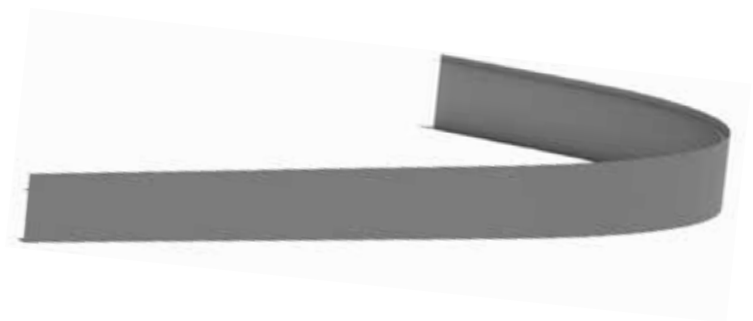

RADIUS

Available in Corten Steel, Stainless Steel, and Powder Coated Aluminum.

These are just a few of the unlimited configurations we are capable of manufacturing.

RETAINING WALL OPTIONS

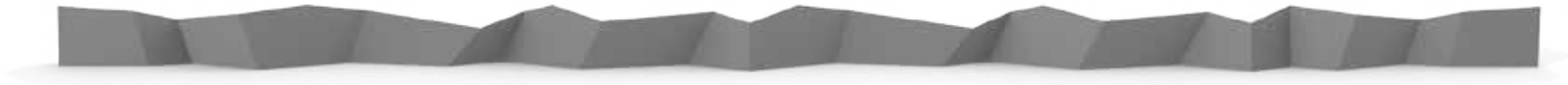

ELEMENT RETAINING WALL

Available in Corten Steel, Stainless Steel, and Powder Coated Aluminum.

Also available as a Planting Bed System.



Element Planting Bed System - Corten Steel prior to patination



PLANTING BED

The Planterworx Planting Bed system is a hybrid between a retaining wall and a traditional planter. This system is manufactured in modular pieces allowing for a nearly seamless installation. All Planting bed systems are typically provided with a bottom unless specified otherwise.

PLANTING BED OPTIONS



U-SHAPED



TAPERED

Available in Corten Steel, Stainless Steel, and Powder Coated Aluminum.

These are just a few of the unlimited configurations
we are capable of manufacturing.

PLANTING BED OPTIONS

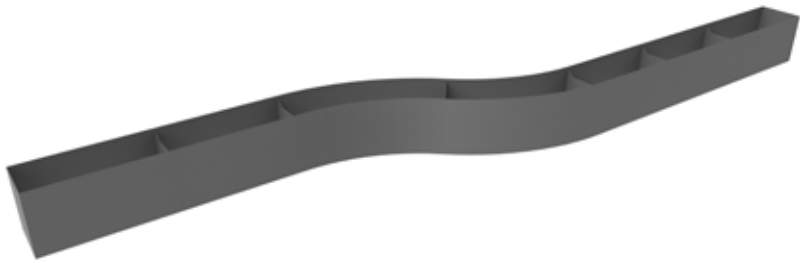

CURVED

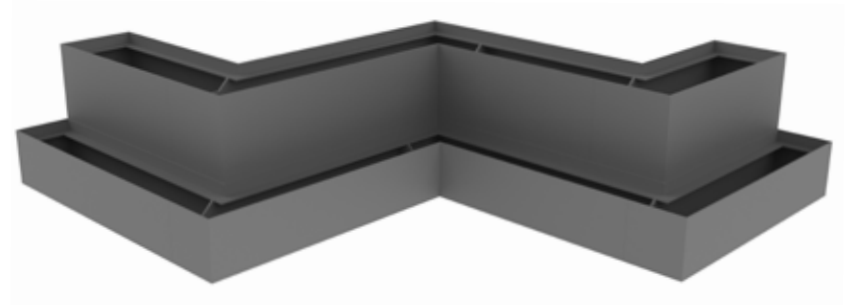

TWO TIER

Available in Corten Steel, Stainless Steel, and Powder Coated Aluminum.

These are just a few of the unlimited configurations
we are capable of manufacturing.



United Nations - Diplomats Garden - Architecture Making Studio - Planting Bed System - Corten Steel



THE PLANTERWORX EDGING SYSTEM

The Planterworx Edging system is a smaller scaled product, similar to the retaining wall system. On structure installations can be manufactured up to 18" in height without compromising the waterproof membrane.

EDGING SYSTEM OPTIONS

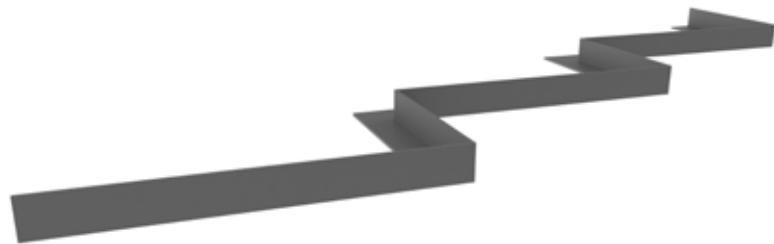

OPEN EDGING

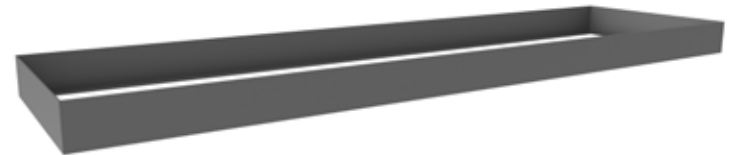

CLOSED EDGING

Available in Corten Steel, Stainless Steel, and Powder Coated Aluminum.

These are just a few of the unlimited configurations
we are capable of manufacturing.



Dune Series - Powder Coated Aluminum



DUNE SERIES

Inspired by sand dunes, these organic forms defy what is capable in metal shaping. Each piece has an ever changing perspective, angle, radii, and profile all at play.

These complex forms can be manufactured in nearly any size and can be designed to accommodate public seating. Perfect for any campus or civic project.



Detail of Dune Series - Powder Coated Aluminum



Dune Series - Powder Coated Aluminum



West 50th - Harrison Green - Custom Planter with Site Screens



PLANTERWORX SITE

Our Site collection is inclusive of large scale planters, integrated seating, site furnishings, trellises, and partition screens. Many of our product examples are intended to serve as inspiration.

Feel free to let your imagination run wild! Our challenge is to create products that are both visually desirable and technically durable. We are capable of a simple selective change or an extensive modification. Tell us your requirements and we will do everything to fulfill them.

THE AERO CHAIR

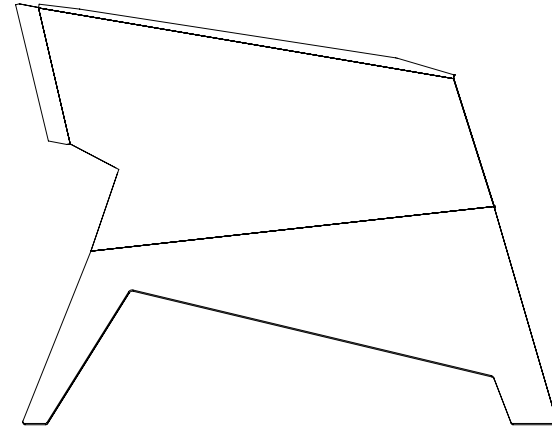
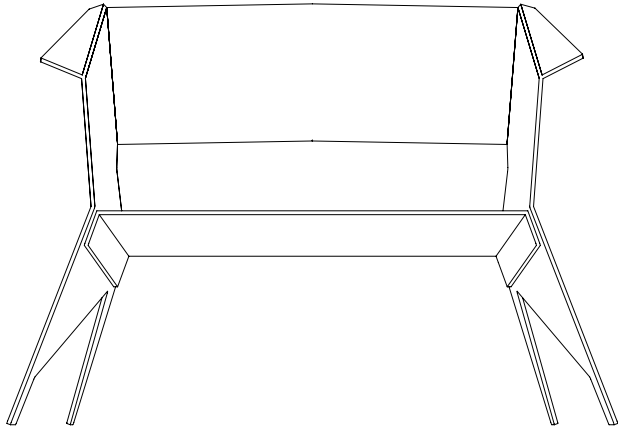

Available in Powder Coated Aluminum



Aero Chair - Matte White Powder Coated Aluminum



New School - Shard Bench - Powder Coated Aluminum

SHARD BENCH



SHARD END PLANTER



SHARD BENCH

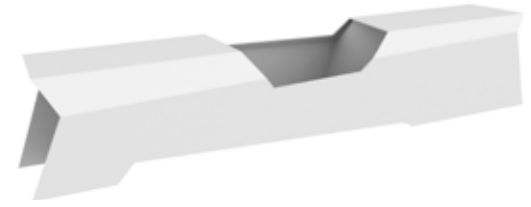

SHARD MIDDLE PLANTER

Available Stainless Steel*, and Powder Coated Aluminum.

*NDSF Only

SITE PLANTER VARIETIES



TAPERED SQUARE

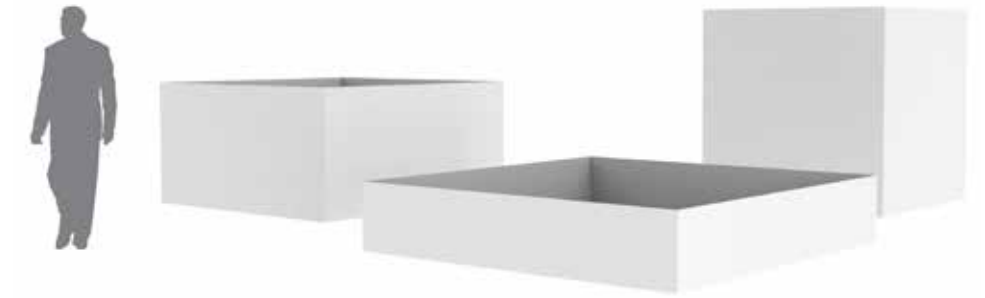

SQUARE

Available in Corten Steel, Stainless Steel, and Powder Coated Aluminum.

Site Planters are available in 33 different sizes, please consult a Planterworx Product Specialist for more information.

SITE PLANTER VARIETIES

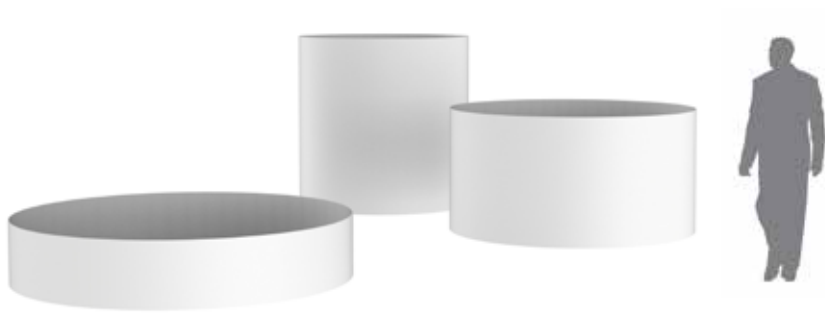

CYLINDER



TAPERED ROUND

Available in Corten Steel, Stainless Steel, and Powder Coated Aluminum.

Site Planters are available in 33 different sizes, please consult a Planterworx Product Specialist for more information.



Union Square - Site Tapered Round - Powder Coated Aluminum



Union Square - Site Tapered Round - Powder Coated Aluminum

SITE
BENCH CONFIGURATIONS



ONE SIDE



TWO SIDE

Available in Corten Steel, Stainless Steel, and Powder Coated Aluminum.



Flatiron - Planter / Bench 60 2 with Timber Seating - Powder Coated Aluminum



De Kas - Planter / Bench 60S 2 with Solid Surface Seating - Powder Coated Aluminum

SITE
BENCH CONFIGURATIONS



L - SHAPE



FULL

Available in Corten Steel, Stainless Steel, and Powder Coated Aluminum.

BENCH MATERIAL OPTIONS



PERFORATED METAL

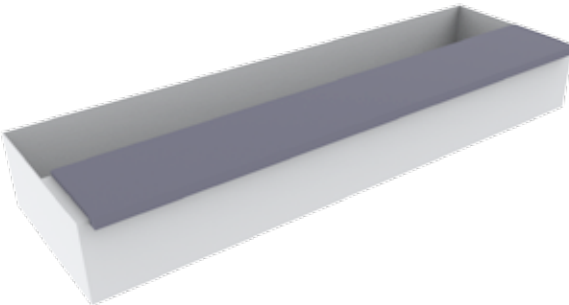

SOLID SURFACE



TIMBER



Washington Square - Planter / Bench 30 | with Perforated Metal Seating - Powder Coated Aluminum

SITE
CUSTOM SCREENS

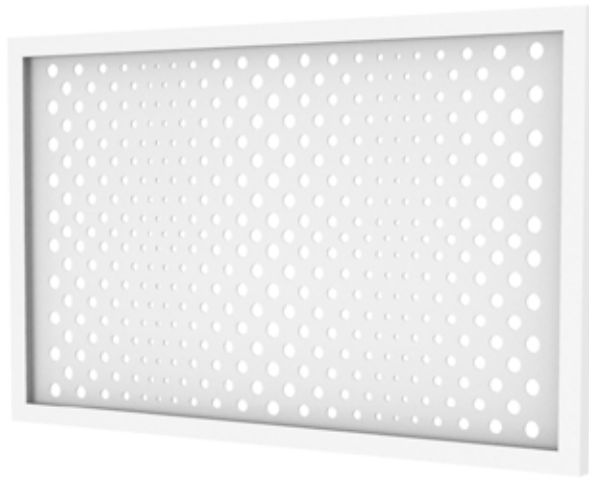

Available in Corten Steel, Stainless Steel, and Powder Coated Aluminum.



West 50th - Harrison Green - Custom Planter with Site Screens



Falchi - Perkins Eastman - Metropolitan Planter - Corten Steel

CORTEN STEEL

Corten steel, also known as weathering steel, provides warm rich textures not always associated with metal. Beautiful earthy hues compliment any environment. Initially, weathering steel was developed for bridge and skyscraper construction where a high tensile strength material was necessary with little or no ability to maintain the area.

Planterworx products are typically manufactured from ASTM A-588 and A-606 alloys.

The patina, or rust, acts as a protective barrier. Weathering steel has a reactive period from 3 to 9 months depending on location and climate. Weathering steel products produce carbon runoff to adjacent materials like stone and concrete.

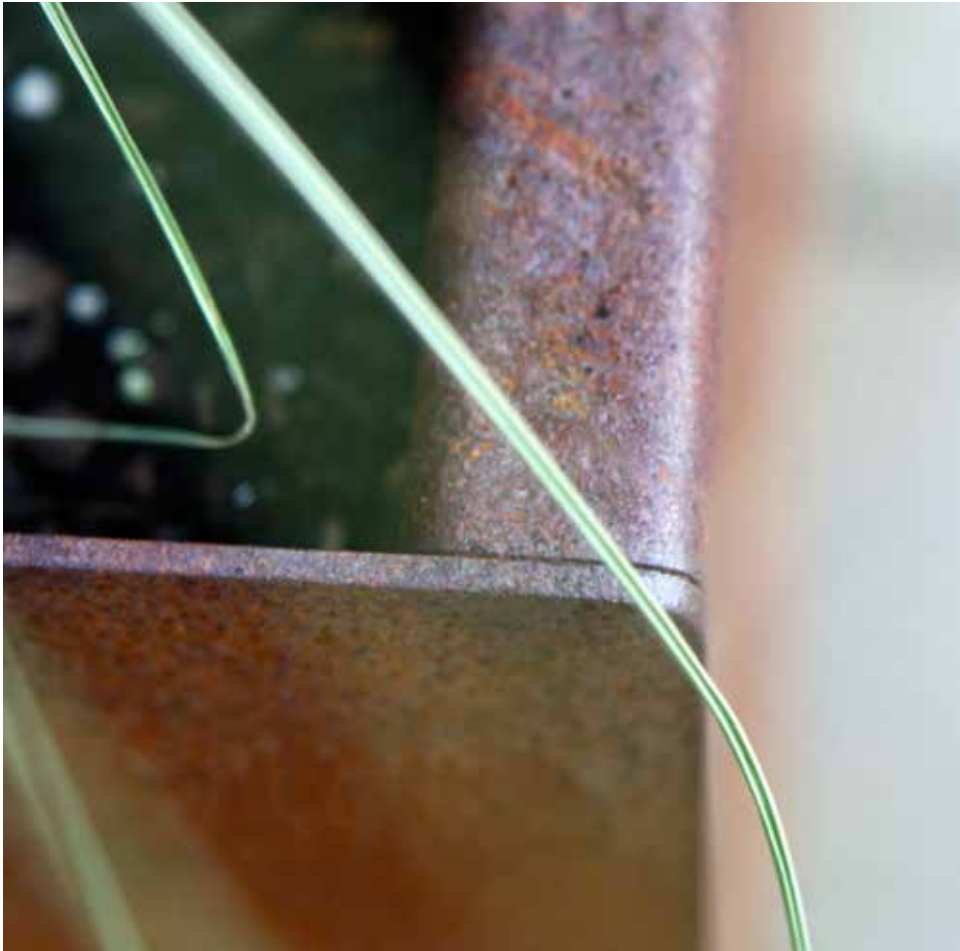

CORTEN STEEL

The stone and concrete can be cleaned with a carbon pacifier to remove any residual runoff. After the initial reactive period, weathering steel will cure and self seal with very little to no carbon runoff. The patination process occurs when water is introduced to the material. To achieve a faster result, weathering steel should be watered and left to dry in the sun. The continued evaporation and introduction of water will accelerate the patination process.

Typically, a .500" space between the face of any weathering steel product and an adjacent material, will mitigate carbon runoff by creating a drainage plane. This is a common detail amongst our retaining wall, planting bed, and edging systems.



Ranch 16 - Pewter Powder Coated Aluminum

POWDER COATED ALUMINUM

Aluminum offers an extremely refined product that is light weight with both high strength and durable properties. Aluminum planter products are ideal for any on structure installation as it is 60% lighter compared to it's stainless and weathering steel counterparts. It typically contains 85% recycled content* and is 100% recyclable. Planterworx products are typically manufactured from ASTM B-209, 5052 Alloy. Aluminum products are offered in a polyester based architectural / marine grade powder coat finish. Planterworx is capable of providing any RAL color selection.



WHAT IS POWDER COATING?

Powder Coating is an advanced method of applying a dry decorative and protective finish. The electrostatic charged powder is a mixture of pigments and bonding agents positively charged and sprayed on to a negatively charged grounded planter:

The charged powder adheres to the grounded planter and is melted and fused into a solid coating in a curing oven. This results in a unique, high quality, and durable finish. The powder coating process does not produce any VOC's (Volatile Organic Compound's) and has a 100% recoupable over spray.

RAL COLOR SYSTEM

RAL is an international standard that allows manufacturers worldwide to associate a color to a number. The RAL number is typically inclusive of the finish unlike liquid paint. Not all RAL colors are available in a matte finish. We are happy to work with you for the appropriate color and finish for your project.

*The Aluminum Association's LEED Fact Sheet for aluminum in sheet & plate for the building and construction market.



The Foundry - Tapered Round 50" H - Stainless Steel NDSF

STAINLESS STEEL

Stainless steel offers a sleek modern aesthetic with highly durable properties. Perfect for any heavily trafficked, civic or institutional environment. Stainless steel is one of the world's most durable and strong materials with excellent corrosion resistance.



STAINLESS STEEL

It is typically 70% recycled and 100% recyclable. Stainless steel products can be offered in a satin brush or an NDSF (non directional satin finish) based on scale, configuration, and order quantity. Planterworx products are typically manufactured from ASTM A-240, T-304 Alloy.

Planterworx also manufactures stainless products in T-316L Alloy upon request. Additional fees may apply. In a coastal environment, Planterworx strongly recommends T-316L material due to its higher corrosion resistance.

FINISHES
NATURALS COLLECTION



STAINLESS STEEL SATIN BRUSH



STAINLESS STEEL NDSF



CORTEN STEEL



OXIDIZED ZINC

As these are natural living finishes, some mottling and surface variation is to be expected. Color can change over time through natural oxidation. Please note that Planterworx does not supply Corten Steel products weathered. The patina / weathering develops over time.

FINISHES
STANDARD POWDER COATED
ALUMINUM

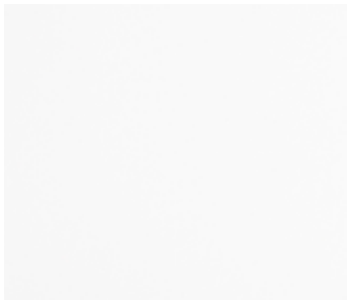

MATTE WHITE



GUNMETAL

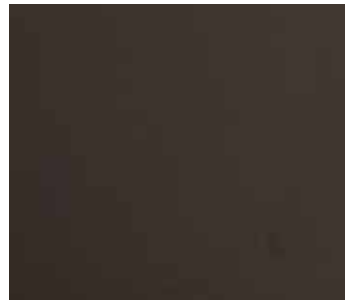

MATTE BRONZE

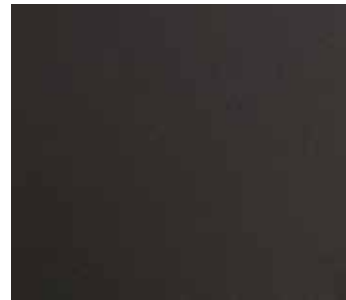

CARBON

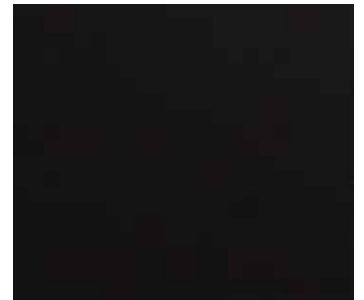

MATTE BLACK

Products can be produced in any RAL color.

Please be aware that the colors displayed within this catalog have been produced electronically. These electronic reproductions are not a substitute for real color samples. Planterworx recommends choosing the final color using standard color cards available upon request.



Downtown Terrace – The Standard Planter – Carbon Powder Coated Aluminum



CARE & MAINTENANCE

Corten Steel

Use fresh warm water once monthly or once weekly in a coastal environment to remove any environmental deposits.

Powder Coated Aluminum

Use fresh warm water and soap once monthly or once weekly in a coastal environment to remove any environmental deposits.

Stainless Steel

Use fresh warm water and soap once monthly or once weekly in a coastal environment to remove any environmental deposits. Stainless steel cleaner can also be used.

Please do not use any abrasive cleaning products or water pressure machines on our products.



Mid-Pike - Clinton & Associates / Design Collective - Planting Bed System - Powder Coated Aluminum



P L A N T E R W O R X

987 Essex Street
Brooklyn, NY 11208

Tel. 718.963.0564
Fax. 718.963.0565

Please contact us for a local sales representative in your area or email us at
info@planterworx.com



P L A N T E R W O R X